



Vetzeria Vistosi S.r.l.

info@vistosi.it

www.vistosi.com

DAMASCO

SP M E27

SPDAMASMCN1

Design PAOLO CREPAX

Due to its versatility, one of our most successful series that has been developed and extended during the years with new versions. It is produced with the bozzolo technique that consists in applying threads of molten glass that create an organic texture.



UNI EN ISO 9001 - CERTIFIED COMPANY



SIZE

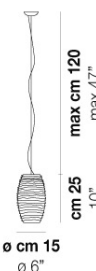

ALTERNATIVE VERSIONS

Click on the version to go to the web version of the product

3 C, 3 P, 36 C, 4 C, 5 C, 5 P, 6 P, CD2, C, GD1, GD2, G, MD1, MD2, P

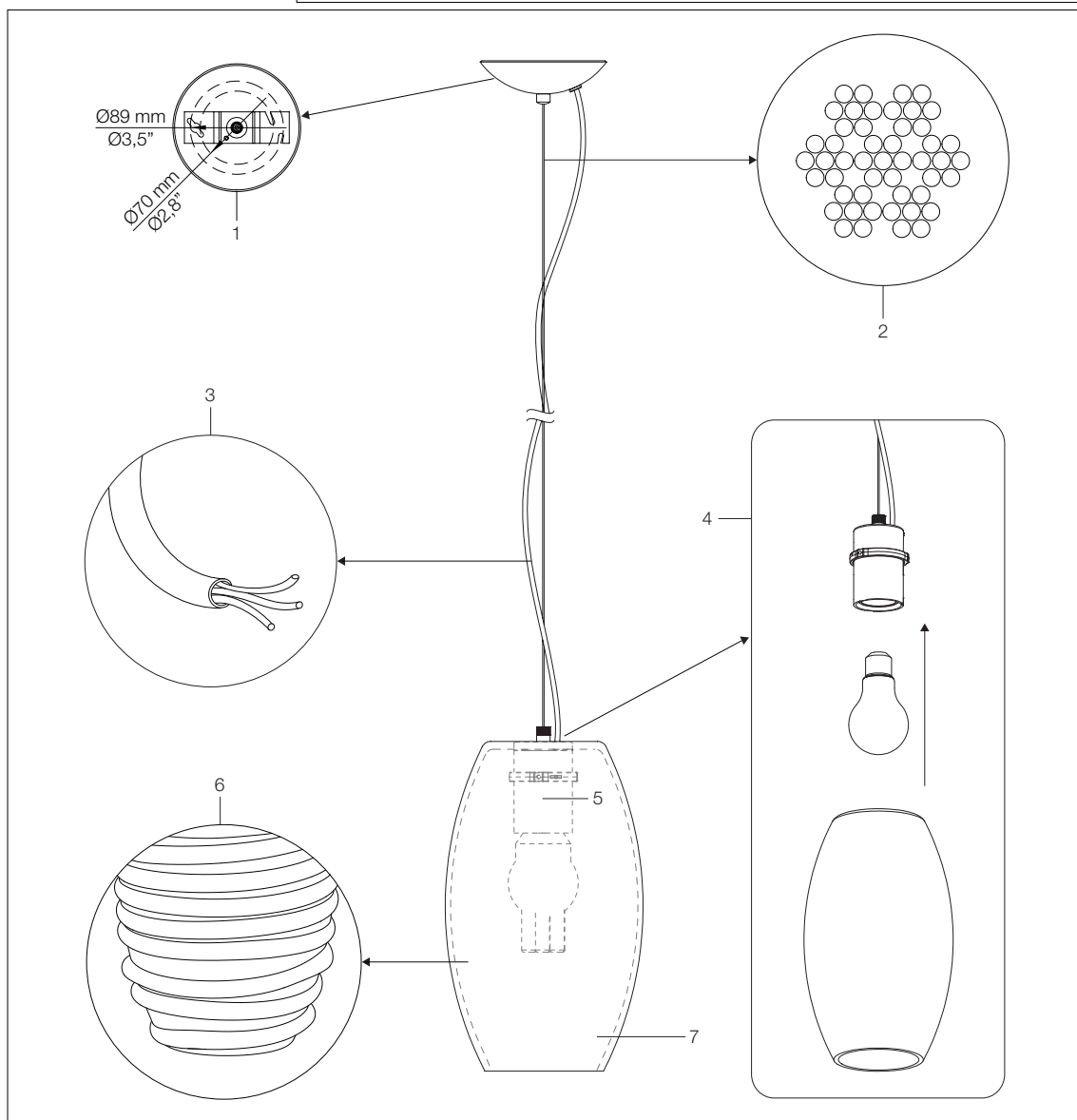

- 1** Metal canopy iron satin nickel finish with a bracket and related share of the distance between holes in the ceiling.
- 2** Stainless steel rope crease resistant of Ø1,2 mm composed of 7x7 wires.
- 3** 3-lines silicone electric wire, section of cables 3x0,75 T° 180.

- 5** Plastic lampholder T° 210 with connection type E27.
- 6** Diffuser in crystal glass entirely handmade and mouth blown. Obtained cocoon with the technique, in which there is the application of glass filament incandescent on the solid surface.
- 7** Unleaded glass with a minimum thickness of 4 mm. The versions with colored glass, the color is not painted but rather got in the mix.

- 4** Frame in satin nickel finish with iron coupling system of glass exclusive Vistosi. Consisting of a main building and a ring which will go to support the glass.

Click to activate (only in Acrobat Reader)

VOLUME: Mc 0,08

GROSS WEIGHT: Kg 6,9

NET WEIGHT: Kg 4,5

SHADE FINISHING

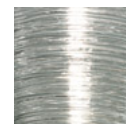

CR/CR CRYSTAL CRYSTAL

FRAME FINISHING



NI SATIN NICKEL

MARKS:



BULBS:

E27 1x77w

ALTERNATIVES:

LED 1x9w