



Vetreria Vistosi S.r.l.
info@vistosi.it
www.vistosi.com

PLOT

SP LED

SPPLOTCRNO

Design A.CHIARAMONTE - M.MARIN



UNI EN ISO 9001 - CERTIFIED COMPANY



SIZE

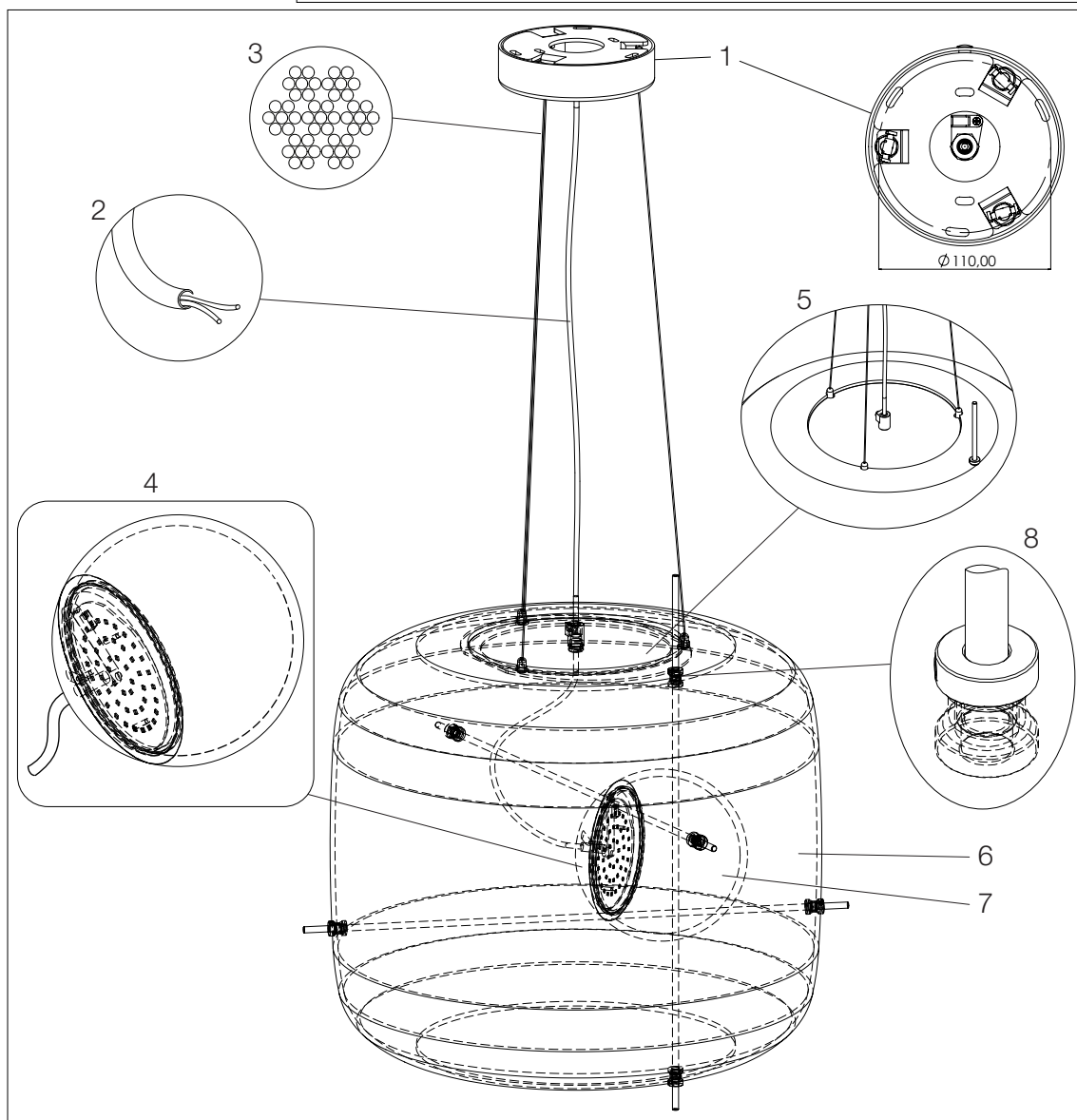
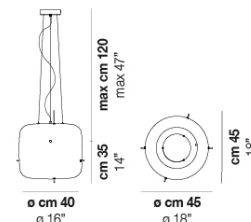

1
Detail of the component for fixing to the ceiling of the lamp.

2
3-lines electrical wire in transparent silicone, conductors section 3x0.75. T°180.

3
Steel rope crease free Ø1,2 mm made of 49 cords.

5
Detail of the metal cover with entrance electric cable and steel cables in the upper end.

6
Light diffuser composed of transparent crystal glass worked ahand, obtained with the exclusive Vistosi glassware technique. Unleaded glass, average diameter of 4 mm with holes made in grinding.

7
Composite light diffuser of 5 crystal-white-crystal layers. Handmade unleaded glass, average diameter 7 mm.

4
LED 12,5 W 1770 LM 3000 K

8
Fixing mechanism of the sliding metal rods. Made of black PTFE teflon with steel grain.

VOLUME: Mc 0,2
GROSS WEIGHT: Kg 15
NET WEIGHT: Kg 9

SHADE FINISHING



CR/NE CRYSTAL BLACK
FRAME FINISHING



NEO BLACK MATT

MARKS:

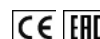
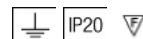

BULBS:

LED N 1x12,5w
1x12,5w